

*Builders*  
CHOICE

# POCKET DOOR



**INSTALLATION GUIDE**



**READ ALL INSTRUCTIONS AND REVIEW DIAGRAMS BEFORE BEGINNING THE INSTALLATION TO GET A THOROUGH UNDERSTANDING OF THE PROCESS.**



**TOOLS NEEDED:**

- Hammer
- Phillips Screwdriver
- Electric Drill
- Drill Bits

*Recommended:*

- 2-1/2" Installation Screws
- 6d 2" Nails

**STEP 1**

Carefully remove packaging from your Builders Choice pocket door frame. Unscrew the header from the inside of the frame (there are two screws—one on the rail and the other on the bottom). Make sure to also remove the hardware packet which is attached by one of the screws.

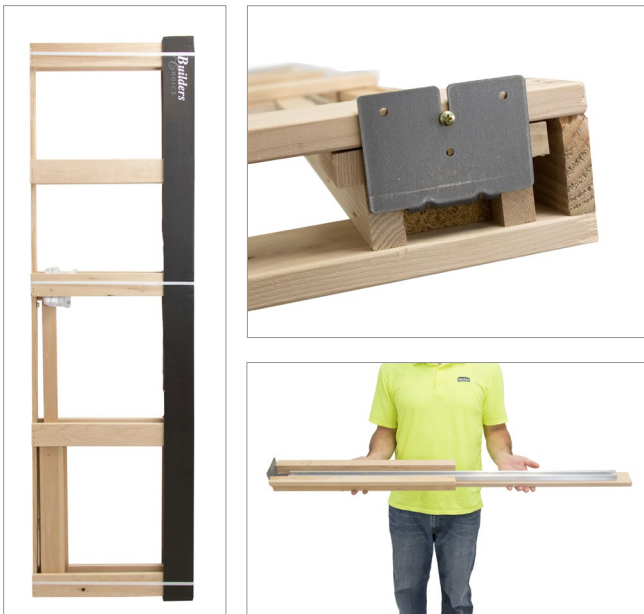

**STEP 2**

Remove the spacer bracket from top of pocket door frame only.



**STEP 3**



Flush aligned for rough opening

Arrange pocket door frame so that the header is resting inside the opening. If the pocket door frame is being installed in a rough opening, the header and end of frame should be flush. If your opening has a finished floor, slide the header inside the frame 3/4".

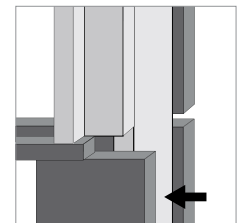

Inset 3/4" for finished floor

**STEP 4**

Hammer three 6d nails into each side of frame, securing the header.

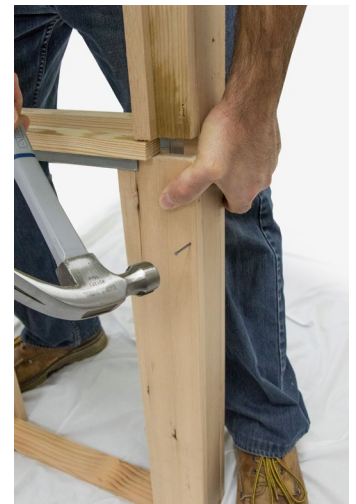

### STEP 5

Place pocket door frame into opening and shim until jambs are perfectly vertical and track is absolutely level (door will not stay in position if track is not level).



### STEP 6A

Ensure header is level. Remove every-other screw from the header and replace with 2-1/2" installation screws.



### STEP 6B



After affixing header, ensure end-plate is fastened into wall stud using 2-1/2" installation screws.

### STEP 7

Make sure frame is plumb. Fasten floor mounting bracket with 2-1/2" screws into floor.



### STEP 8

Remove spacer bracket from middle of pocket door frame.





### STEP 9

Slide wheel-hangers onto track from either end.



### STEP 10

Attach door plates onto top of doors, 2" from edge (make sure the lock tab openings are on the same side).

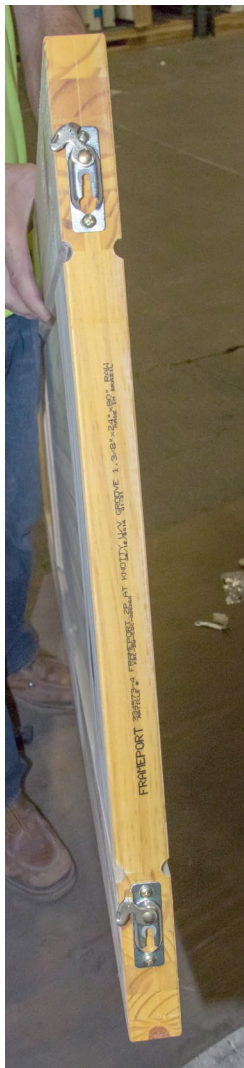

### STEP 11

Mount door by inserting wheel-hanger into door plates. Ensure door closes evenly on jamb and that there is adequate clearance at floor. If adjustments are needed, raise/lower the wheel-hanger bolt, using the included wrench.



### STEP 12

After ensuring door is plumb and closes properly, you may now hang your drywall or wall boards and trim out your opening.

